

Citizens Advisory Council Mission

- 1| Encourage an open discussion among all parties.
- 2| Provide representation for, and accurate information to, your constituent group.
- 3| Provide feedback on project issues and analysis.

Airport Layout Plan

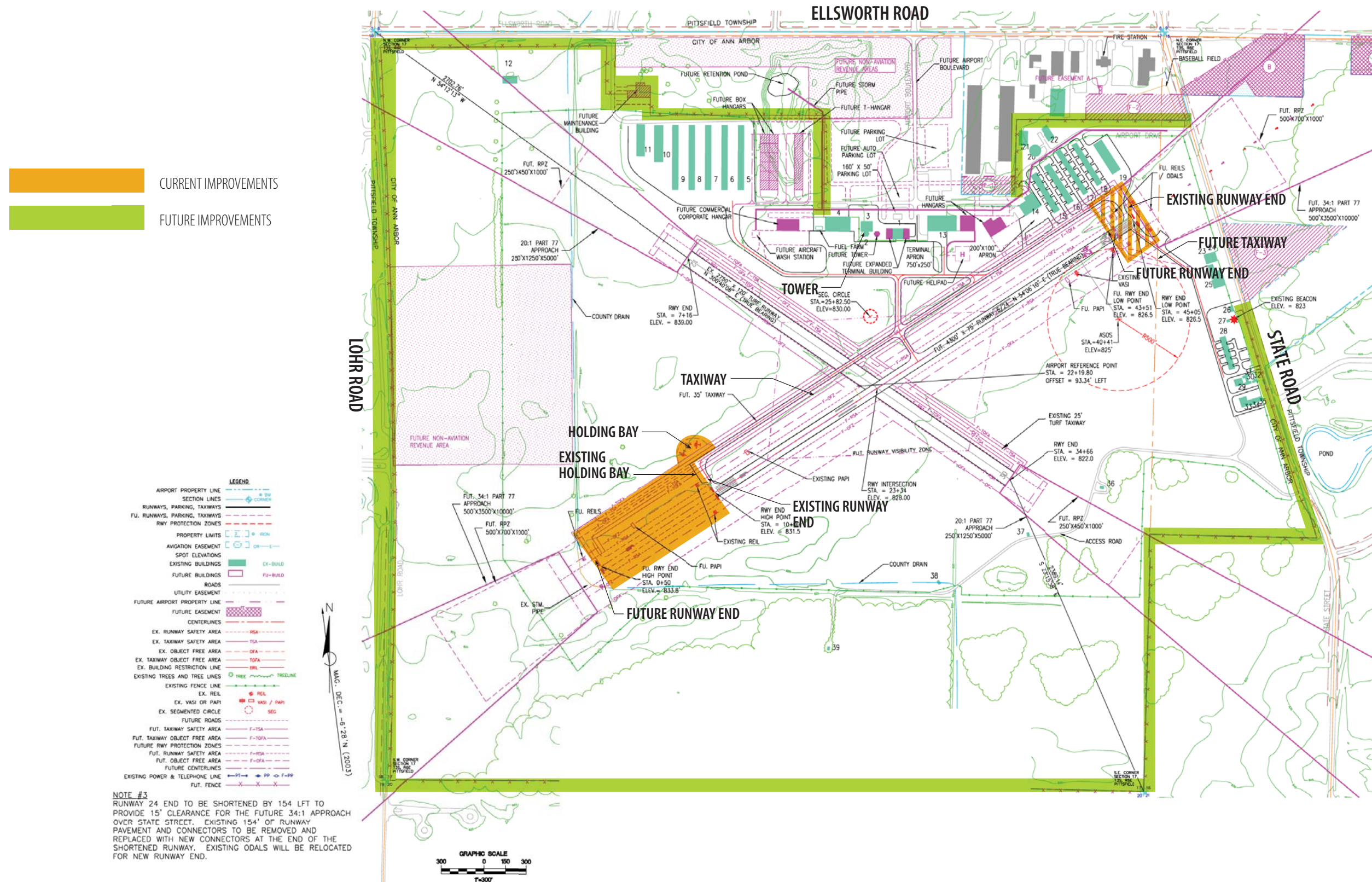

Project Goals and Objectives

- 1| Address the need for a future 34:1 approach slope on Runway 24.
- 2| Minimize the FAA tower line of sight issues.
- 3| Minimize the occurrence of runway overrun incidents.
- 4| Provide sufficient airfield facilities to accommodate aircraft presently using the airport.
 - Improve safety conditions during periods of high temperatures and inclement weather.
 - Accommodate fully loaded aircraft currently using the airport.

Airport Improvements

- 1| Extend Runway 6/24 and parallel taxiway, from 3505 feet to 4300 feet.
- 2| Shift Runway 6/24 and parallel taxiway 150 feet to the southwest.
- 3| Shift holding bay to the northeast.

Project Schedule

Environmental Assessment and Public Involvement Tasks + Milestones

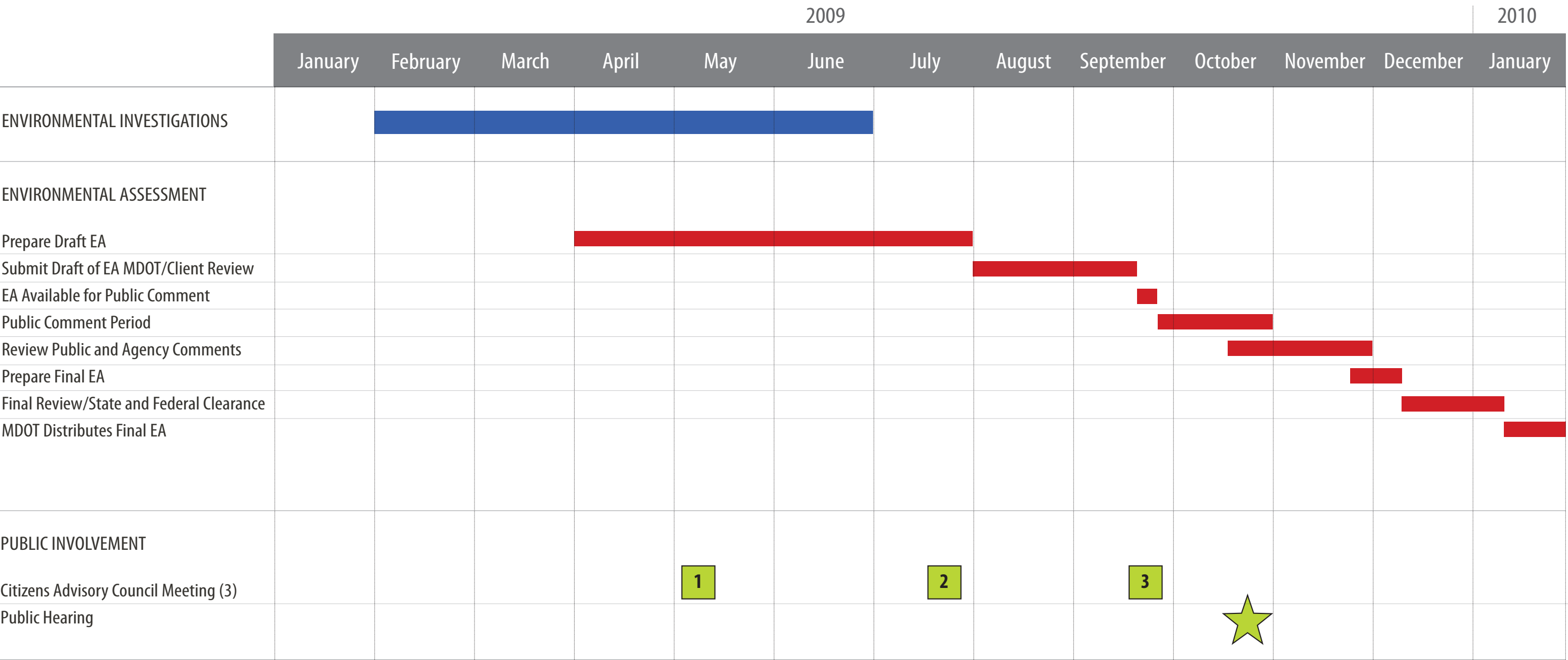

Existing Conditions

